

### Features:

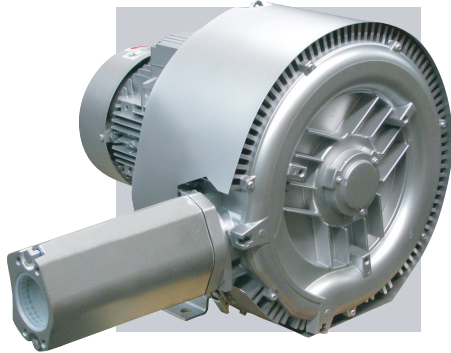

- Cooler running, outboard bearing provides maintenance-free operation
- Environmentally friendly oil-free technology
- Extremely quiet operation
- All motors are standard TEFC with Class F insulation, UL recognized, CE Compliant  
*Explosion-Proof motors available*
- Custom construction blowers are available
- Rugged die cast aluminum construction

Performance curve for Vacuum pump

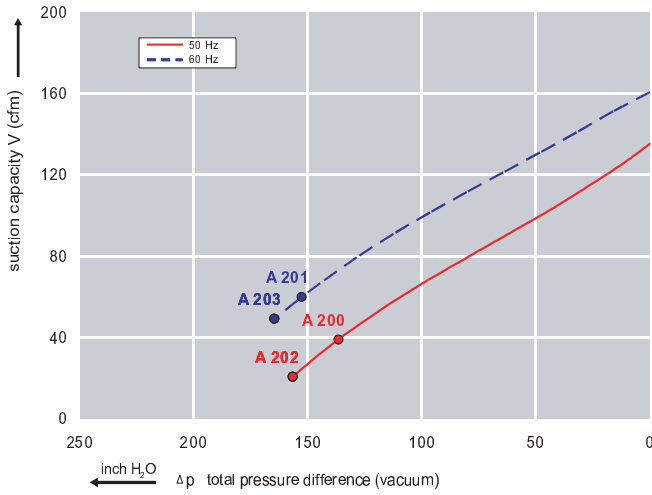

Performance curve for Compressor

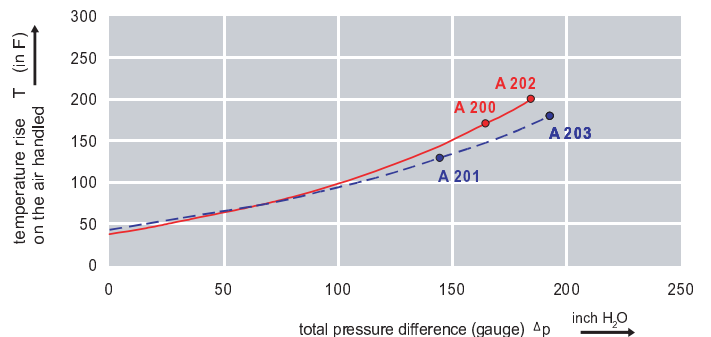
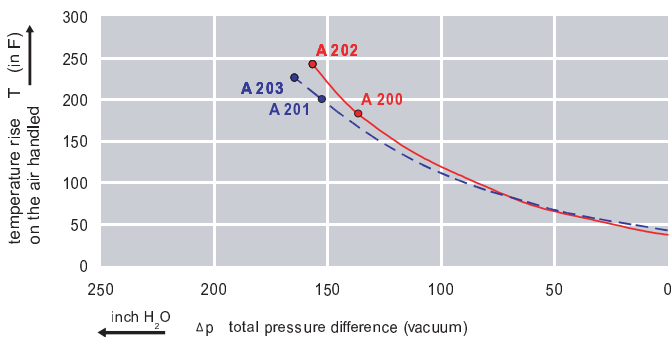
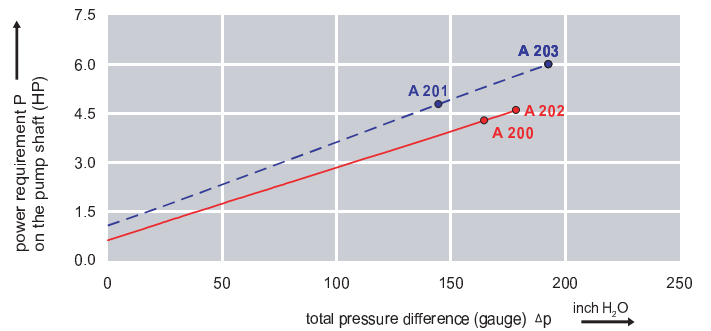
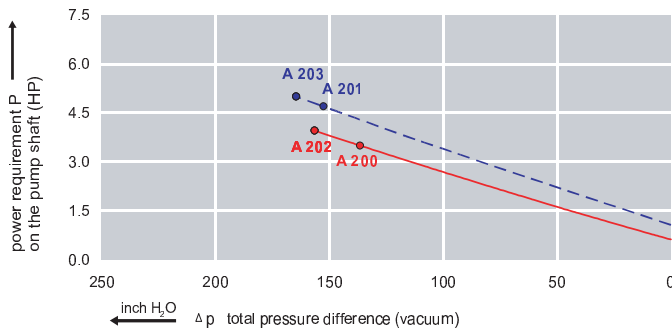
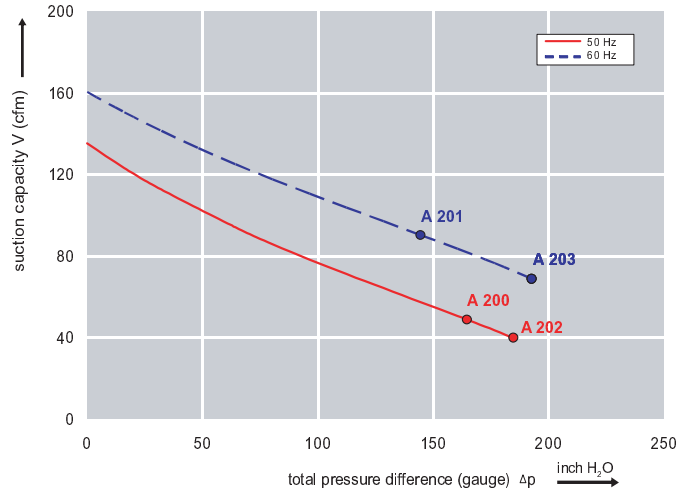

### Dimensions: (inches)

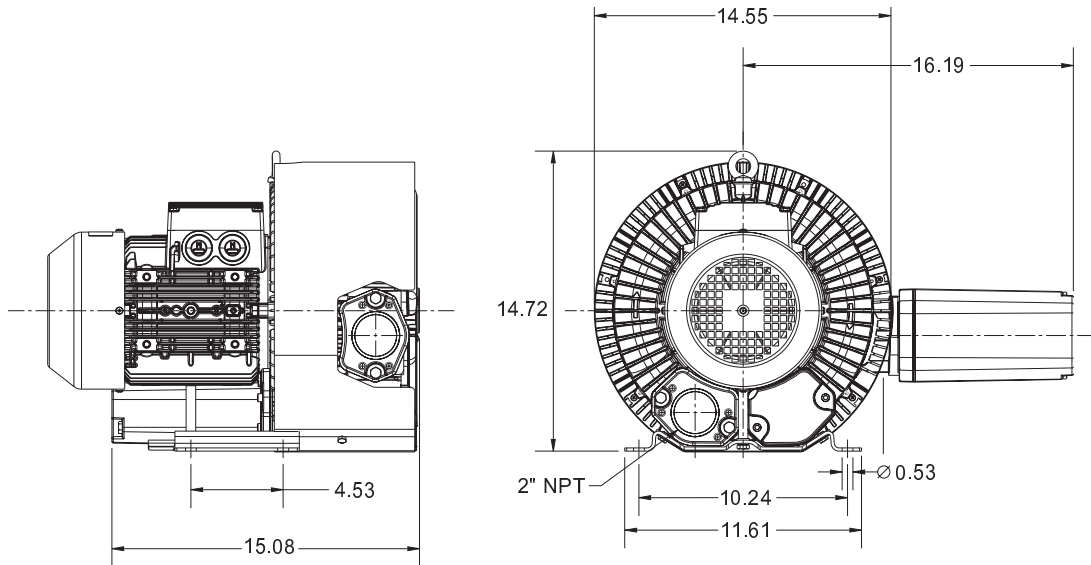

### Recommended Accessories:

#### Relief valve:

VC61Z (Vacuum)  
PC61Z (Pressure)

#### Filter:

ATF-200-15124/1  
(Vacuum)  
AFS-30-200-10  
(Pressure)

Specifications subject to change without notice. Please contact factory for specification updates.

### Selection & Ordering Data - Type 3BA1510

Curve No.	Order No.	Fre- quency Hz	Rated power HP	Input voltage		Input current		Permissible total differential pressure		Sound pressure level dB(A)	Weight lbs
				V		A		Vacuum inch H2O	Compressor inch H2O		
<b>3~ 50/60 Hz IP55 insulation material class F</b>											
A 200	3BA1510-7AT46	50	4.02	200D ... 240D	345Y ... 415Y	12.5D	7.2Y	-136	165	72	86
A 201	3BA1510-7AT46	60	4.62	220D ... 250D	415Y ... 460Y	12.0D	6.5Y	-153	145	74	86
A 202	3BA1510-7AT56	50	5.36	200D ... 240D	345Y ... 415Y	17.4D	10.0Y	-157	197	72	95
A 203	3BA1510-7AT56	60	6.16	220D ... 250D	415Y ... 460Y	15.2D	8.5Y	-165	193	74	95

Suitable for 208 Volt Operation

All curves are rated at 14.7 psia and 68°F ambient conditions and are reported in SCFM referenced to 68°F and 14.696 psia sea level conditions. Curve values are nominal, actual performance may vary by up to 10% of the values indicated. For inlet temperatures above approximately 80 °F or for handling gases other than air, please contact your Airtech sales representative for assistance.